



Dear Friends,

HJA Design Studio has a simple mission statement:

“Provide our clients with the highest quality work that creates lasting, positive and recognizable places.”

We continue to do that in Florida and overseas in collaboration with architects, engineers, golf course architects and, of course, our clients.

This is our first newsletter, and we are pleased to share some of our recent work with you. We look forward to working with you in 2011.

Michael Houston, ASLA

Albert Jacob, ASLA

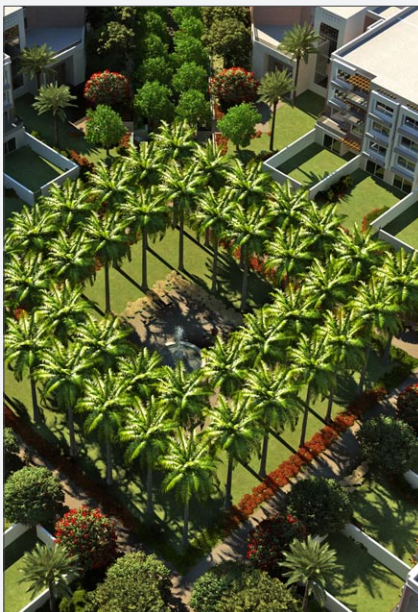

PARK DESIGN IN CAIRO'S NEWEST PLANNED COMMUNITY

The 1500 acre New Giza planned community in the suburbs of Cairo, Egypt, has opened its first phase of homes in the “Neighborhood 2” section of the development which includes a 16 acre (6.4 hectares) park designed by HJA Principal and Design Studio Director, Albert Jacob, ASLA.

The site plan, prepared by New Giza Design Studio and Earth Architecture, is organized around five 3-story condominium building clusters, each with its own two to four acre community park. One of the parks includes a small lake with low fountains that will create a cooling effect for the entire park area as it takes advantage of prevailing northwest winds.

Mr. Jacob created connected yet changing experiences by incorporating a series of meandering paths, uninterrupted by auto conflicts, playgrounds, covered gathering areas and small gardens to encourage a wide variety of uses. A green oasis for residents in this land of barren landscapes, the parks welcome pedestrians in a country where evening strolls are an important part of the social culture. The parks are within close proximity to the planned community sports and social club which features specialty restaurants, tennis courts and a center court, as well as fields for soccer, volleyball, handball and basketball.

Head Architect Amr Ghaly of New Giza Design Studio describes the parks in Neighborhood 2 as “a wonderful amenity for our new residents who are looking for a place to live that allows a tranquil and uncongested contrast to busy Cairo.”



The Parks at New Giza Neighborhood 2 are designed to be the premier outdoor gathering places for residents in this developing new suburb of Cairo.





EXUMA BAY RESORT MAKING PROGRESS IN THE BAHAMAS

A great new eco-friendly mixed-use resort is taking shape in the southern Exumas on the island of Great Guana Cay. Just twenty minutes by air from the main island of Nassau, this enchanting island destination will include two major resort hotels with 200 and 160 rooms respectively, each offering spectacular views of Exuma Bay or the Atlantic Ocean.



The yacht club featuring a 100-slip marina is currently under construction and will provide service for boats up to 150'. A spa, tennis and tennis clubs, restaurants and more than 4000 linear feet of white sandy beaches are designed to make this resort destination unlike others. Straddling the Atlantic and the Caribbean, a world-class golf course will emphasize the site's numerous 80' elevation outlooks. Eighty single family homesites and 60 condominium units are also included in the project design.

Albert Jacob, Principal in Charge, calls the resort "one of the most intriguing and beautiful sites I have worked on in my career."



HJA is providing land planning and landscape architectural services for this spectacular resort destination.

Tempting views of Caribbean seas, the Atlantic Ocean and more than 4000 linear feet of white sandy beaches are central to the design of the Exuma Bay Resort on the island of Great Guana Cay, Exumas, Bahamas.



MARTIN COUNTY APPROVES COMMERCE PARK AND URBAN BOUNDARY MOVE

In a landmark decision tied to local economic development efforts, the Martin County Board of County Commissioners approved a number of land use amendments for the 250 acre 7th Edition Commerce Park which included a movement of the urban service boundary. That decision was supported by the Florida Department of Community Affairs (DCA) last month when they offered no objections to its approval.

The park, which will be the County's first planned under PUD standards, is located near the I-95 and State Road 76 interchange just fifteen minutes from the Jupiter and Port St. Lucie life science campuses. The project includes 75 acres of waterfront related land use designations which abut the St. Lucie/Okeechobee Waterway and are intended to support Martin County's and Florida's marine industries. The remainder of the park is planned for office, distribution, research and manufacturing users.

Michael Houston and the HJA Studio planning staff provided the planning and representation throughout the nearly 18-month approval process.

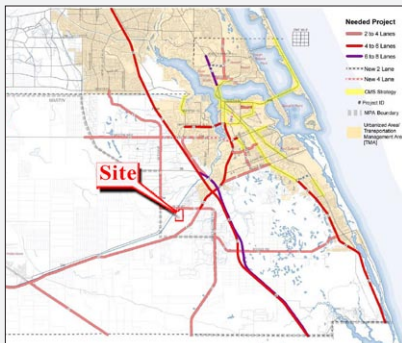

7th Edition Conceptual Site Plan

HJA was instrumental in the Martin County Board of County Commissioners decision to move the urban service boundary to accommodate the new 7th Edition Commerce Park.



PORT ST. LUCIE FLOOD PROTECTION MOVING FORWARD

During the twin hurricanes of 2004 and Hurricane Wilma in 2005, large portions of the City of Port St. Lucie's southeastern neighborhoods in the Lennard Road / U.S. 1 corridor experienced significant flooding.

In an effort to alleviate future flooding, the City is currently planning and permitting the Eastern Watershed Improvement Plan (EWIP) which will include nine separate parcels and approximately 48 acres of created lake areas which are interconnected and drain through Howard Creek. The project will provide 350 acre feet of new stormwater storage to the basin. This regionally significant and technically challenging project will also provide water quality benefits and recreational opportunities to local neighborhoods.

HJA's LEED AP Robin Pelensky worked with Rhett Keene, P.E. of CAPTEC Engineering, and Assistant City Manager Greg Oravec to design the project's upland plantings and hardscapes. Low maintenance, drought tolerant native plants comprise the majority of the plant palette while flowering accent trees and royal palms will highlight key locations.

Mr. Oravec calls the EWIP project "one of the most significant stormwater projects in the City's history and a unique urban greenway."

Howard Creek Stormwater Improvement Plan - HJA's landscape design for one of nine parcels in the City of Port St. Lucie's Eastern Watershed Improvement Plan.

HJA participated in several public meetings which gave local residents the opportunity to view new stormwater improvement designs slated for their neighborhoods.



TAYLOR ESTATE DESIGN CREATES CONNECTIONS

While expansive river vistas are paramount in this grand residence nestled on the Intracoastal Waterway, the property's remaining 2.5 inland acres required significant attention. Architects Garcia & Stromberg invited HJA Design Studio to devise a creative solution that provides for a cohesive landscape which joins the home's main living area with the guest house, the garage and beyond.

HJA's Albert Jacob concentrated on bringing water views to the home's other exposures as well. Water cascades from the fountain at the center of the new entry court and a formal internal courtyard with fountain becomes the focal point from the main living areas. Flowering trees line the entrance path and create shaded lounge areas around the existing pool.

Bougainvillea brightens columned and trellised walkways which provide comfortable connections from the residence to the many outdoor living areas. A Japanese style garden graces the view from the master bathroom, while lush tropical plantings and palms surround the new riverside outdoor dining space area on the south side.

Water views will abound from every window at this waterfront estate home in South Florida. HJA's Albert Jacob designed a series of inviting outdoor living spaces connected by covered pathways and colorful tropical plantings. A Japanese garden beckons from the master bathroom.

